

## **2013 Asphalt Paving of Streets Addendum #2**

**To: All Bidders**

**From: Michael L. Heintz, City Engineer**

**Date: March 19, 2013**

**Re: Changes to Bid Proposal Quantities (Revised Bid Proposal Form); Revision of Engineer's Estimate for Alternate #1; Revised Attachment B; Correction to Technical Specifications (Removals, Excavation, and Embankment-Alternate #1); Correction to Technical Specifications (Special Items-Alternate #1)**

### **Changes to Bid Proposal Quantities (Revised Bid Proposal Form)**

Due to some changes made to Alternate #1, the bid proposal form shall be revised accordingly. Specifically, pages 17 and 18 of the bid documents shall be replaced by revised pages 17 and 18 that are included with this addendum. The revised pages 17 and 18 shall supersede and replace the previous versions of these pages.

### **Revision of Engineer's Estimate for Alternate #1**

The Engineer's Estimate for Alternate #1 shall be revised to be \$30,000.00. This revised estimate shall be supersede and replace previous estimates for Alternate #1 of \$57,000.00 (original bid document) and \$60,000.00 (addendum #1). Wherever the Engineer's Estimate for Alternate #1 was written previously, this figure shall be replaced with \$30,000.00.

### **Revised Attachment B**

The revised Attachment B (dated 3/18/2013) included with this addendum shall supersede and replace the previous version of this document.

### **Correction to Technical Specifications (Removals, Excavation, and Embankment-Alternate #1)**

Under the Technical Specifications (Section III), the section titled "Removals, Excavation, and Embankment-Alternate #1" on page 47 shall be retitled to read "Excavation and Embankment". The first paragraph of this section about removals shall be deleted. The removal of the specified wall and fence shall be deleted from the project.

### **Correction to Technical Specifications (Special Items-Alternate #1)**

Under the Technical Specifications (Section III), the first sentence under the section titled "Special Items-Alternate #1" on page 48 shall be revised to read as follows: "Concrete parking blocks shall be per ODOT Standard Construction

Drawing RM-6.1". The permanent steel bollards shall be deleted from the project.

**2013 Asphalt Paving of Streets**

Master Sheet Proposal

*Base Bid*

ITEM NO.	DESCRIPTION	UNIT OF MEASURE	APPROX.	UNIT COST	TOTAL COST (a x b)
			QUANTITY (a)		
254	PAVEMENT PLANING, ASPHALT CONCRETE	S. Y.	5,984		
407	TACK COAT @ 0.08 GAL/SY	GAL.	1,071		
411	STABILIZED CRUSHED AGGREGATE, BERMS	C. Y.	6		
448	ASPHALT CONCRETE, SURFACE COURSE, TYPE 1, PG 64-22	C. Y.	564		
604	MANHOLE, ADJUSTED TO GRADE	EACH	11		
614	MAINTAINING TRAFFIC	LUMP	1		
624	MOBILIZATION	LUMP	1		
632	DETECTOR LOOP	EACH	2		
638	WATER VALVE, ADJUSTED TO GRADE	EACH	5		
644	CHANNELIZING LINE, 12"	FEET	35		
644	DOUBLE YELLOW SOLID CENTER LINE	FEET	285		
644	LANE ARROW	EACH	1		
103.05	CONTRACT BOND	LUMP	1		
SPEC	PETROTACK, 12"	FEET	200		
<b>BASE BID TOTAL</b>					

*Alternate #1 (E. Market St. parking lot, 100 block, north side)*

ITEM NO.	DESCRIPTION	UNIT OF MEASURE	APPROX.	UNIT COST	TOTAL COST (a x b)
			QUANTITY (a)		
203	EXCAVATION, AS PER PLAN	C. Y.	17		
203	EMBANKMENT, AS PER PLAN	C. Y.	19		
254	PAVEMENT PLANING, ASPHALT CONCRETE	S. Y.	1,615		
407	TACK COAT @ 0.08 GAL/SY	GAL.	130		

448	ASPHALT CONCRETE, SURFACE COURSE, TYPE 1, PG64-22	C.Y.	68		
452	8" CLASS 'C' PLAIN CONCRETE, DRIVE APPROACHES	S.Y.	70		
608	4" CONCRETE SIDEWALK	S.F.	228		
609	BARRIER CURB, TYPE 6	FEET	154		
609	COMBINATION CURB AND GUTTER, TYPE 2	FEET	136		
614	MAINTAINING TRAFFIC, AS PER PLAN	LUMP	1		
630	REMOVE AND RESET EX. SIGN & POST	EACH	1		
630	SIGN, FLAT SHEET	S.F.	4		
630	GROUND MOUNTED SUPPORT, 2" SQUARE POST	FEET	24		
644	4" PARKING STALL	FEET	580		
644	HANDICAP SYMBOL	EACH	1		
659	SEEDING AND MULCHING	S.Y.	22		
SPEC	CONCRETE PARKING BLOCK, AS PER PLAN	EACH	1		
SPEC	MISCELLANEOUS, AS PER PLAN	LUMP	1		
<b>ALTERNATE #1 TOTAL</b>					

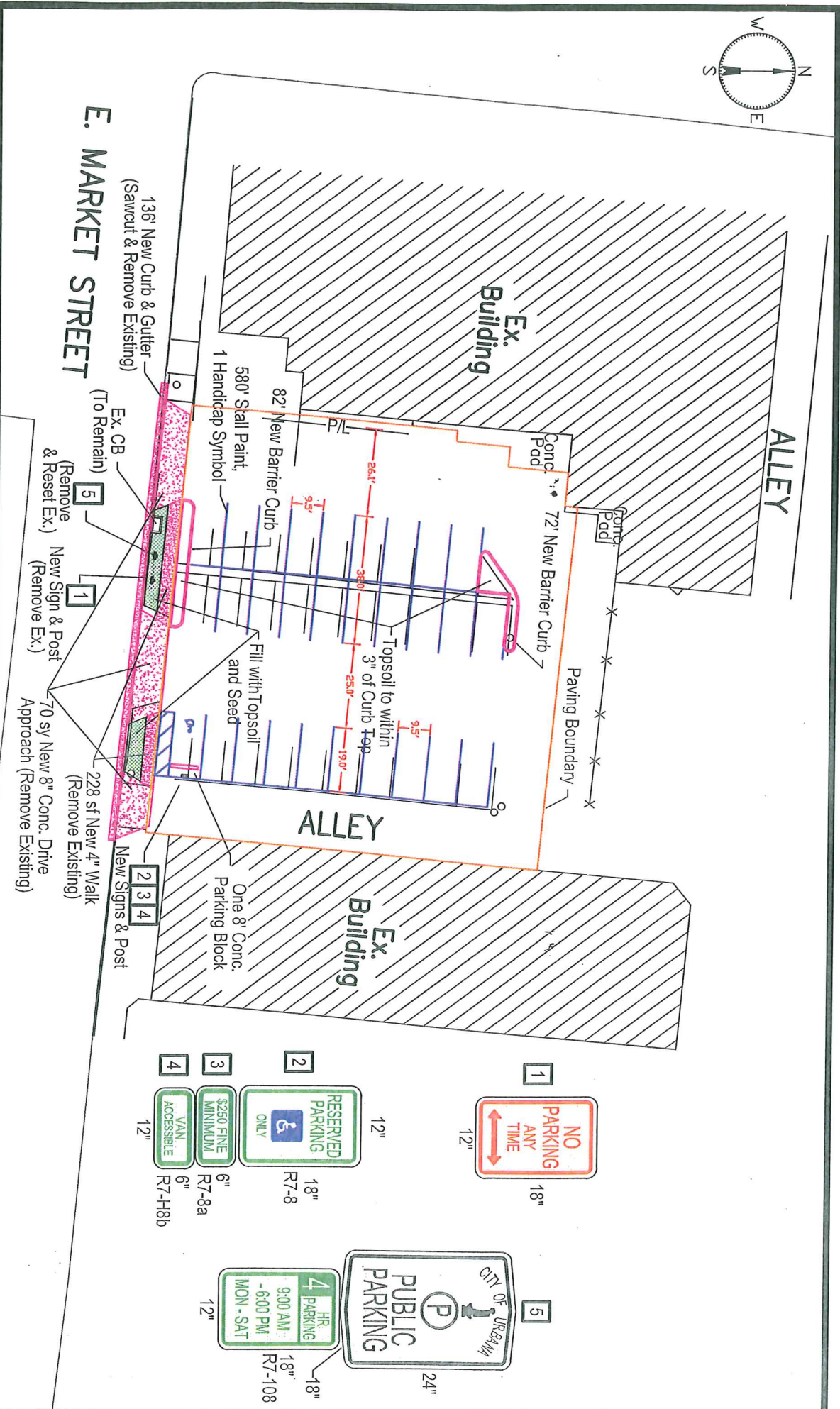
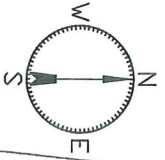

CAD FILE: G:\Engineering\Urbana Map\Street Paving Map.dwg  
 DRAWN BY: TLB  
 APPROVD BY: MLH  
 SCALE: 1" = 40'  
 ISSUE DATE: 2-28-13  
 REVISION DATE: 3-18-13

**2013 Asphalt Paving of Streets**  
**Alternate #1 - Market St. Parking Lot**  
 Michael L. Heintz, P.E., P.S.  
 CITY ENGINEER

CITY OF URBANA  
 DIVISION OF ENGINEERING  
 205 S. Main Street Urbana, Ohio 43078  
 Phone: (937) 652-4306  
 Fax: (937) 652-4321

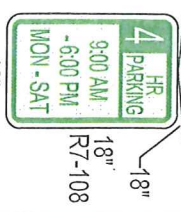
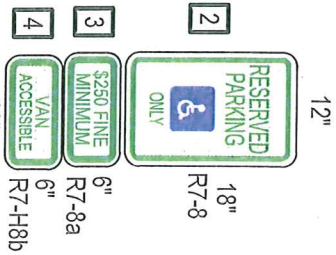

18"

R7-8

6"

R7-8a

6"

R7-H8b

18"

R7-108